

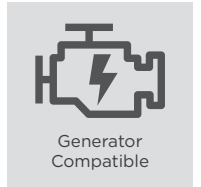

ENERGY-SAVING TOWER UPS

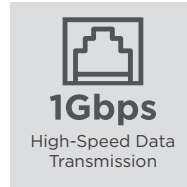
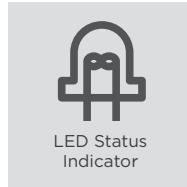
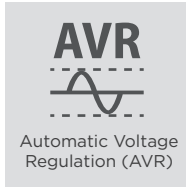
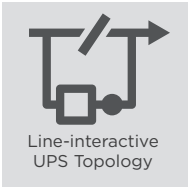

Energy-saving UPS systems save up to 93% of power consumption

Designed for home and office applications, the UT Series adopts line-interactive topology with Automatic Voltage Regulation (AVR) function to offer stabilized AC power output. The patented GreenPower UPS™ Bypass design achieves ultra-low power consumption to reduce energy costs. The LED indicator shows the utility, battery and operating status of the UPS. Other features include overload protection, EMI filter and configurable alarm to safeguard your devices.

SERIES FEATURES

- Energy Saving Technology
- Automatic Voltage Regulation (AVR)
- Generator Compatible
- LED Status Indicator
- Overload Protection
- Surge and Spike Protection
- Phone/Fax/Modem/DSL/Network Protection
- High-speed Ethernet Data Transmission
- Configurable Alarm
- EMI and RFI Filtration

PRODUCT CALLOUTS

1. Power On/Off Switch
2. LED Status Indicators
3. Surge Protected Outlets
4. Battery Backup & Surge Protected Outlets
5. Input Circuit Breaker
6. Communication Protection Ports (RJ11/RJ45)

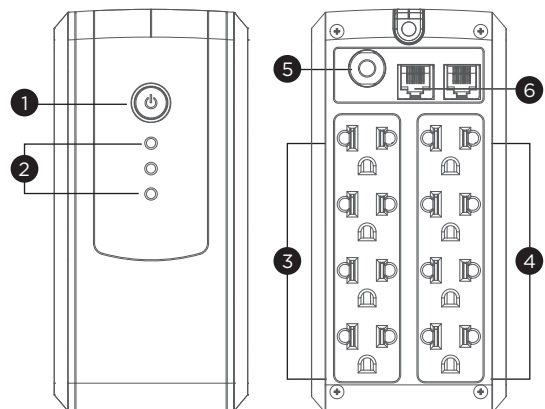

UT800EG



TECHNICAL SPECIFICATIONS

Model Name	UT800EG
General	
UPS Topology	Line-interactive
Energy Saving Technology	GreenPower UPS™ Bypass Technology
Input	
Generator Compatibility	Yes
Nominal Input Voltage (Vac)	230 ± 10%
Input Voltage Range (Vac)	165 - 290
Input Frequency (Hz)	50 ± 5, 60 ± 5
Input Frequency Detection	Auto-sensing
Rated Input Current (A)	2.83
Input Connector Type	NEMA 5-15P
Output	
Capacity (VA)	800
Capacity (Watts)	480
On Battery Waveform	Simulated Sine Wave
On Battery Voltage(s) (Vac)	230 ± 10%
On Battery Frequency (Hz)	50 ± 1%, 60 ± 1%
Automatic Voltage Regulation (AVR)	Single Boost, Single Buck
Overload Protection	Internal Current Limiting, Circuit Breaker
Outlet(s) - Total	8
Outlet Type	AS x 8
Outlet(s) - Battery & Surge Protected	4
Outlet(s) - Surge-Only Protected	4
Typical Transfer Time (ms)	4
Battery	
Runtime at 60W (min)	30
Runtime at 90W (min)	18
Typical Recharge Time (Hours)	6
User-replaceable	No
Battery Type	Sealed Lead-acid
Replacement Battery Pack	RBP0143
RBP Quantity (pcs)	1
Surge Protection & Filtering	
Surge Suppression (Joules)	150
EMI/RFI Filtration	Yes
Phone/Network Protection RJ11/RJ45 (Combo)	1-in, 1-out
Management & Communications	
LED Indicators	Power On, Line Mode, Battery Mode, Bypass Mode, Low Battery, Overload, UPS Fault
Audible Alarms	Battery Mode, Low Battery, Overload, UPS Fault
Ethernet Data Transmission Speed	Up to 1Gbps
Physical	
Form Factor	Tower
Physical Size - UPS Module	
Dimensions (WxHxD) (mm.)	84 x 174 x 280
Weight (kg.)	4
Environmental	
Operating Temperature (°C)	0 - 40
Operating Relative Humidity (Non-condensing) (%)	0 - 90
Online Thermal Dissipation (BTU/hr)	34
Certifications	
RoHS	Yes

#All specifications are subject to change without notice.